

TOWNSHIP 3 S., RANGE 9 W.W.M. TILLAMOOK COUNTY ORE.

SCALE 2 IN. = 1 MILE

CHAS. F. METSKER CIVIL ENGINEER
514 S.W. OAK STREET, PORTLAND, ORE.
TACOMA, WASH.

- 1 - COUNTY
- 2 - LEROY & ELLA WOODS
- 3 - " " "
- 4 - D.W. GILBERT (ESTATE)
- 5 - D.W. " "
- 6 - FED. LAND BANK
- 7 - D.W. GILBERT (ESTATE)
- 8 - CLAYTON A. MEAD
- 9 - A.L. BAYS
- 10 - RHODA SCHOPPERT
- 11 - " " "
- 12 - " " "
- 13 - W.J. ARMBURST
- 14 - H.E. WARREN
- 15 - A.M. HARE
- 16 - METHODIST CHURCH
- 17 - WESLEY SCHULMERICH
- 18 - BERTHA BRANSON & JENNIE HOSTETLER

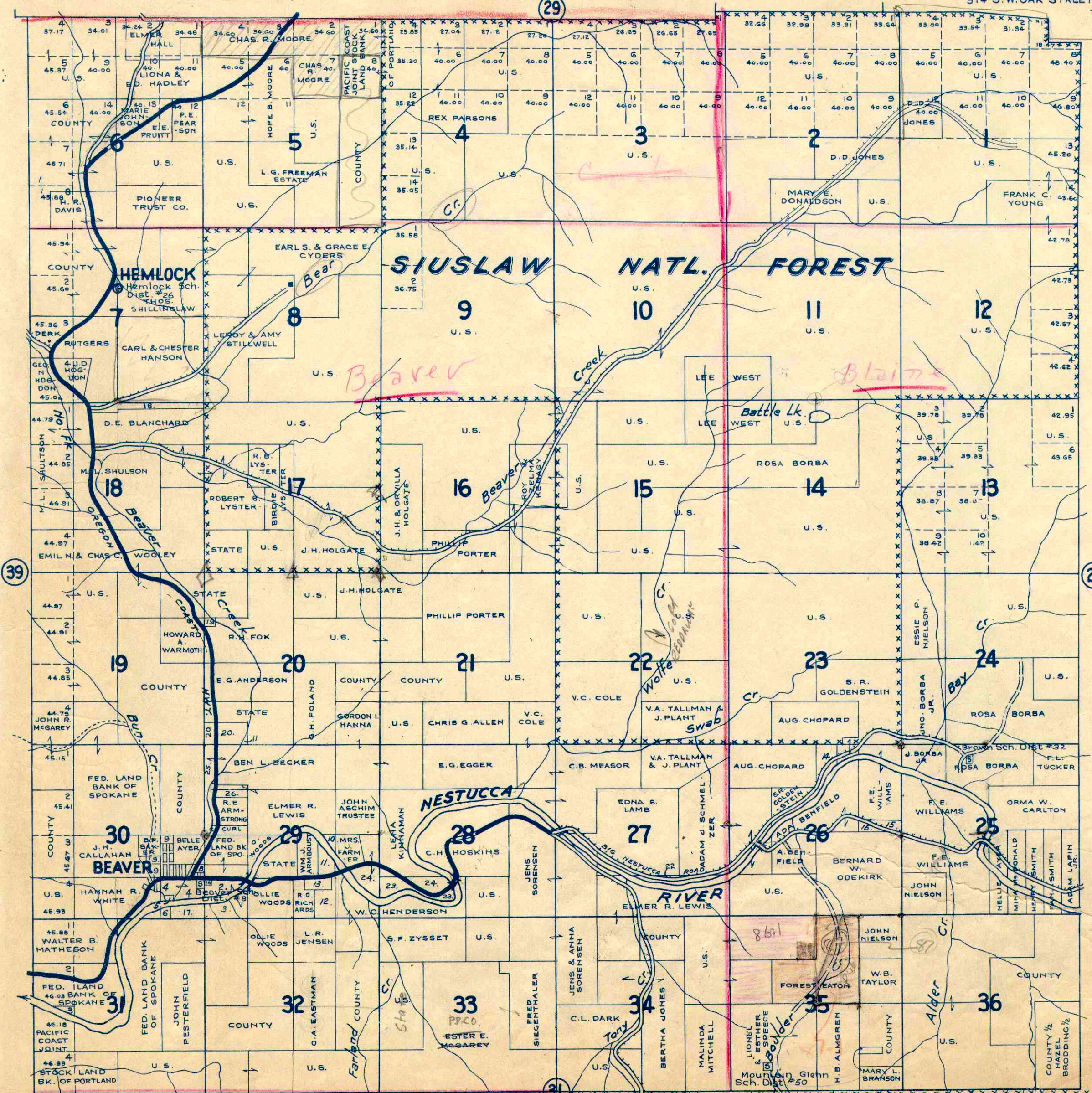

LEGEND

- PAVED ROADS
- IMPROVED DIRT ROADS
- OTHER ROADS
- TRAILS
- RAILROADS
- ELE. RWYS.
- SCHOOLS